

# Yellow LED Push Button Switch Indicator

This yellow LED push button switch indicates elevator or switch positions. It is designed for industrial environments and complies with IEC/EN60947-5 standards.

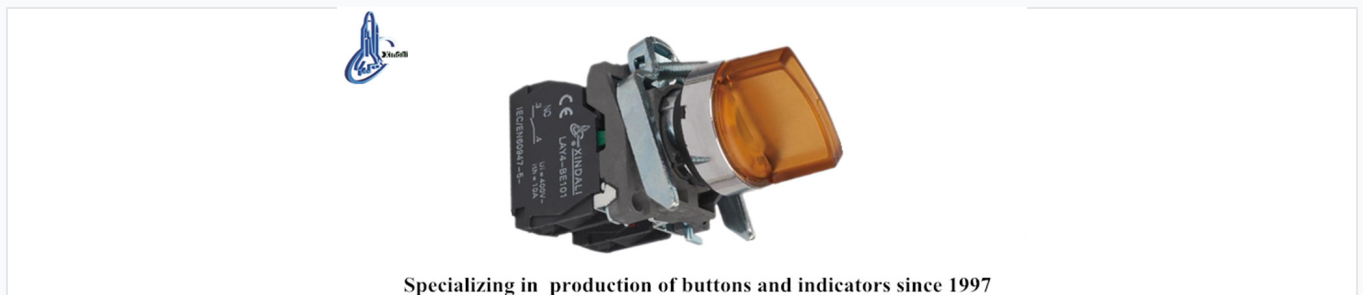

## Product Overview



Standard yellow LED illuminated push button indicator for elevator and control systems.

## Industrial Switch Indicator

This yellow LED push button switch indicator is designed for high-performance control circuits in industrial environments, including elevator systems and control panels. Engineered with a durable zinc alloy and high-grade anti-flam plastic construction, it ensures reliability and safety. The unit features silver alloy contacts for superior anti-electrical erosion resistance and is fully compliant with IEC/EN60947-5 standards.

## Electrical Ratings

Rated Insulation Voltage	600 V
Conventional Heating Current	10 A
Voltage Wave	20 %
Withstand Voltage	AC 2.5KV/min

## Performance Metrics

### Operating Metrics

<b>50 M<math>\Omega</math></b> Insulation Resistance	<b>60 cd/m<sup>2</sup></b> Brightness	<b>100000 cycles</b> Pushbutton Mechanical Life
<b>Electrical Life</b>	500,000 cycles (pushbutton)	

## Physical Specifications



Standard handle  
with LED  
2 Position stay put  
3 Position stay put

N/O + N/C  
220~240V

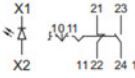

- White/PW
- Green/PG
- Yellow
- Pure Blue
- Red

- LAY4-BK2165
- LAY4-BK2365
- LAY4-BK2565
- LAY4-BK3665
- LAY4-BK3465

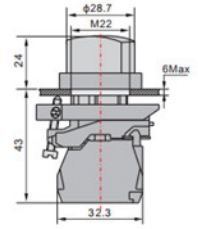

**LAY4-BK2565**

Dimensional diagram showing mounting size and construction details.

### Dimensions

Feature	Value
Mounting Size	M22
Base Width	32.3 mm
Overall Height	43 mm
Max Panel Thickness	6 mm

### Compliance & Standards

Certifications

CE, ISO 9001, ROHS, UL, IEC 60947-5-1