

# Washing Machine Electric Motor

This electric motor is designed for automatic washing machines. The motor ensures efficient operation and reliable performance in home appliances.



## Product Overview

### High-Performance Washing Machine Motor

This series electric motor is specifically engineered for automatic washing machine applications. Featuring a robust metallic housing and precision-engineered shaft for power transmission, it ensures reliable and efficient operation. The design incorporates standardized mounting brackets and wiring, making it ideal for integration into modern home appliances requiring dependable performance.

## Technical Specifications

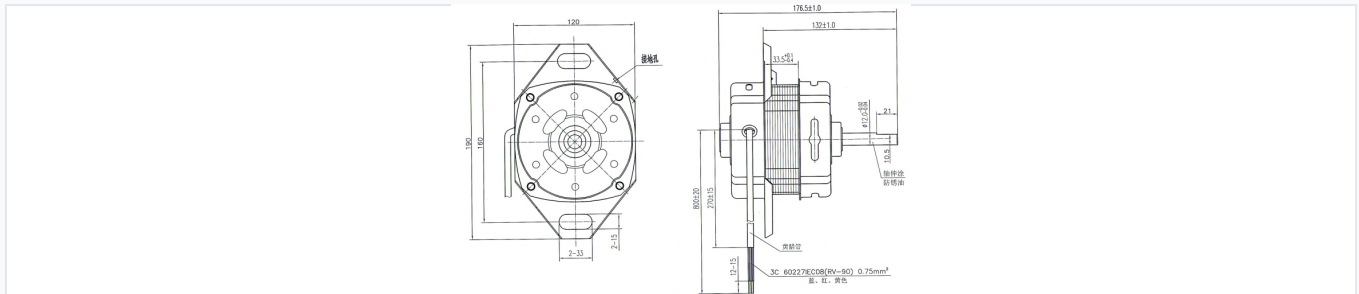

Technical diagram showing shaft dimensions, mounting hole locations, and wire specifications.

Shaft Diameter	12 mm
Shaft Extension Length	21 mm
Motor Body Length	132 mm
Overall Length	176.5 mm
Cable Specification	3C 60227IEC08(RV-90) 0.75mm <sup>2</sup>
Wiring Configuration	Blue, Red, Yellow

## Dimensions

### Mounting Hole Spacing

- 15mm
- 33mm

### Total Assembly Height

**800 mm**

Total Height

**270 mm**

Body Height

### Front Face Width

120 mm