

# Spring Return Projecting Push Button Switch with Symbol

This spring return switch features a projecting push button with a symbol. It is designed for use in controlling circuits in a range of electrical applications.



## Overview

### Professional Control Switch

The LAY5-EL4322 is a high-performance spring return projecting push button switch, engineered for reliable signal control and interlocking in industrial electrical circuits. Built with a durable zinc alloy body and high-grade anti-flame plastic, it features silver alloy contacts to minimize electrical erosion. This versatile switch is compatible with AC voltages up to 660V and DC voltages below 400V, making it an ideal choice for control panels, machinery, and power distribution systems.

## Technical Specifications

### Mechanical Life

**1000000 cycles**

Pushbutton

**500000 cycles**

Selector Switch

### Electrical Life

**5000000 cycles**

Pushbutton

**250000 cycles**

Selector Switch

Rated Insulation Voltage	600 V
Conventional Heating Current	10 A
Insulation Resistance	e5M©
Contact Resistance	d25©
Power Frequency Withstand Voltage	AC 2.5KV/min

## Design & Construction



LAY5-EL4322

Convex button  
Spring return  
Marked

N/C



Red



stop

LAY5-EL4322

LAY5-EL4342

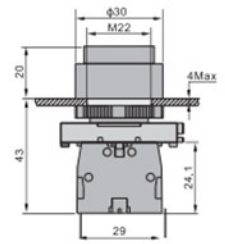

Dimensional drawing highlighting the M22 mounting standard and overall profile for easy integration into control panels.

### Contact Configuration

Normally Closed (NC)

Mounting Hole Diameter

22 mm

Switch Type

Spring Return Projecting Push Button

## Compliance



Specializing in production of buttons and indicators since 1997

High-quality industrial push button switch featuring standard compliance markings and clear terminal identification.

Certifications & Standards

CE, ISO 9001, RoHS, UL, IEC 60947-5-1, GB/T14048.1