

# Robotic Vacuum Cleaner with Gyro Navigation

This robotic vacuum cleaner utilizes gyro navigation for comprehensive cleaning. It has a 2000 mAh Li-ion battery, 1500 Pa suction power, and smart app control for scheduling and monitoring.

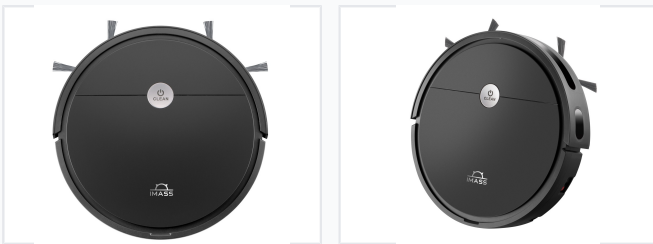

## ADDITIONAL IMAGES



## Overview



Low-profile design and advanced sensors allow for automated cleaning under furniture while avoiding obstacles.

## Versatile Robotic Cleaning Solution

This robotic vacuum cleaner offers a comprehensive 3-in-1 solution by combining sweeping, vacuuming, and mopping functionalities in a single device. Equipped with advanced gyroscope navigation and professional AI technology, it ensures efficient coverage of areas between 80 to 110 square meters. Its low-profile design and smart sensor array allow it to navigate seamlessly under furniture while avoiding obstacles and falls.

## Performance Metrics



The 1500Pa suction motor is paired with a high-efficiency dual-filter system including a HEPA filter.

### Key Performance Metrics

**1500 Pa**

Suction Power

**2000 mAh**

Battery Capacity

**120 min**

Max Working Time

## Cleaning System

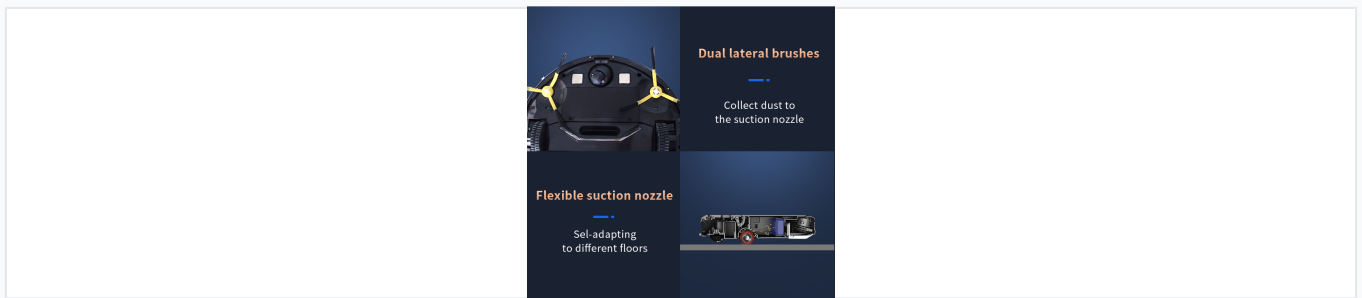

Dual lateral brushes and a self-adapting flexible suction nozzle ensure efficient debris collection on various floor types.

### Suction Mechanism

- BLDC Motor with Cyclon Tech
- Flexible self-adapting suction nozzle
- Dual lateral brushes for dust collection

### Cleaning Functions

Sweep, Vacuum, Mop, Auto Cleaning, Schedule Cleaning, Spot Cleaning, Edge Cleaning

## Filtration & Air Quality

### Filtration System

HEPA Filter • Ultrafine Air Filter • Dual-Filter System

## Navigation & Intelligence

### Safety Features

- Anti-falling sensors
- Anti-collision sensors
- Anti-tangling system

### Navigation Technology

GYRO Navigation with Professional AI

## Smart Connectivity

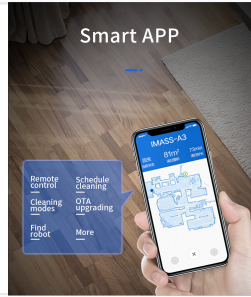

Full control via smartphone app including scheduling, mode selection, and real-time cleaning statistics.

### Smart App Capabilities

- Tuya Smart / SmartLife App Support
- Remote Control
- Real-time status monitoring
- OTA Upgrading
- Find Robot feature

## Technical Specifications

### Technical Data

| Parameter     | Value                   |
|---------------|-------------------------|
| Coverage Area | 80 - 110 m <sup>2</sup> |
| Battery Type  | Li-ion                  |
| Recharge      | Automatic               |
| Navigation    | Gyroscope               |