

# Retail Security Retractable Tether Box

This security tether box uses a retractable cable to safeguard displayed merchandise. It allows customers to handle items while preventing theft in retail environments.



## ADDITIONAL IMAGES



## Product Overview

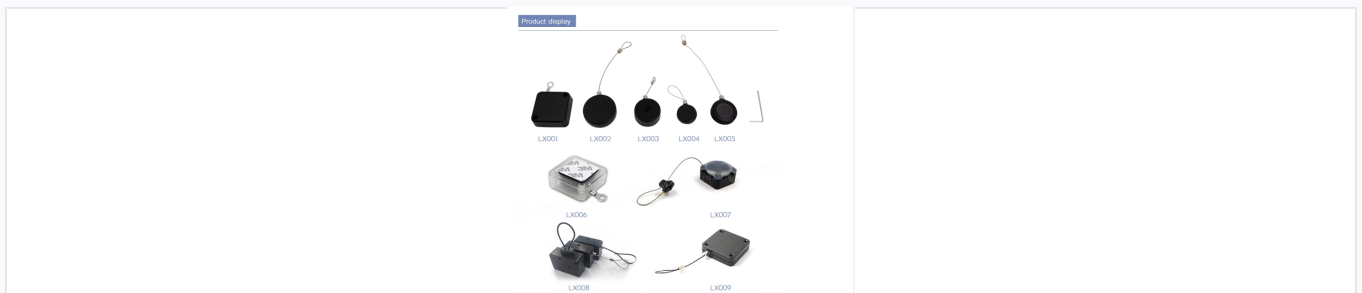

A variety of housing shapes and sizes are available to suit different retail display requirements.

### Versatile Retail Security Solution

This retractable anti-theft pull box is designed to protect high-value merchandise while allowing customers to interact freely with display samples. Featuring a durable ABS housing and a high-strength stainless steel cable, it provides a discreet yet effective mechanical security measure for retail and exhibition environments. The system is easy to install via adhesive or screw mounting, making it an ideal choice for securing electronics, jewelry, and eyewear.

## Technical Specifications

### Key Performance Metrics

<b>90 cm</b> Lanyard Length	<b>0.6 mm</b> Cable Diameter	<b>32 mm</b> Unit Diameter
--------------------------------	---------------------------------	-------------------------------

<b>Material</b>	ABS plastic housing with stainless steel internal cable
<b>Unit Dimensions</b>	32mm Diameter x 11mm Height

## Installation & Use

This reel can work together with any end fitting or mounting base / holder (as shown on our website) from us. It can be installed to the confined space on the back of display cabinet. Fixing can be made by screw or adhesive tape. Pull box is made of ABS plastic, with stainless steel cable winding onto the reel inside. For cable end exits, you can select middle / side exit. There is a stable & invariable retraction force for the cable.

The pull box features a stainless steel cable and can be mounted via adhesive or screws in confined spaces.

### How to use!

#### Be Professional

Be at ease.....



**Usage:**  
The 3M glue on the back of the pull box is fixed on the display table or other hidden places, through pulling the wire rope, the display and anti-theft functions can be achieved. Different products need different ports to be used together.

Easy 3M adhesive mounting allows for quick installation on display tables or hidden surfaces.

### Cable Exit Configuration

- Middle Exit
- Side Exit

### Simple Setup

Fix the pull box to a display table or hidden location using the pre-applied 3M adhesive or screws. Connect the cable end to your product using the appropriate port or loop. The stable retraction force ensures the cable returns smoothly after customer handling.

### Mounting Methods

3M Adhesive Tape, Screw Fixing, Hidden Installation

## Applications

### Advantage

- Retail or exhibition Security Display Pull Box recoiler with Loop/ Stop End/ Screw hole.
- Mechanical security for glasses, watch, and anything could be tied.
- It helps to sale when customers can handle sample

Mechanical security for items like glasses and watches, facilitating sales by allowing customer interaction.



### Application



Multiple end-fitting options available to secure a wide range of product types.

### Ideal For Securing

- Mobile Phones
- Cameras
- Watches
- Eyewear
- Electronic Accessories

## Logistics & Compliance

### Certifications

CE • ISO Approved

### Standard Packaging

Quantity	Weight	Carton Dimensions
150 pcs/ctn	1.3 kgs	26 x 15 x 18 cm

### Supply Ability

1,000,000 pieces per week