

Precision Bearing Assembly with Dimensional Specifications

This precision bearing assembly is designed for industrial applications requiring precise rotational movement and load bearing. It features multiple sections with varying diameters and lengths, including sections labeled A, B, C, and D.

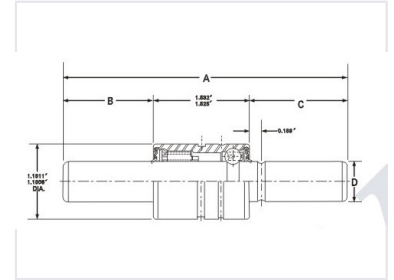

Product Overview

Precision Bearing Assembly

This precision bearing assembly is engineered for demanding industrial applications that require high-accuracy rotational movement and reliable load-bearing performance. The design incorporates multiple distinct sections with varying diameters and lengths to ensure a precise fit within complex mechanical systems. Built for durability and exacting tolerances, this component is an essential solution for machinery requiring rigorous dimensional stability.

Dimensional Specifications

Diameter D Range

1.1811 in

Max Diameter D

1.1806 in

Min Diameter D

Internal Section Lengths

- 1.682
- 1.626

Offset Dimension

0.189 in

Technical Details

Design Features

Precision Engineered, Multi-Section Geometry, Industrial Grade, High Tolerance