

Portable Digital Pulse Oximeter

This portable device accurately measures blood oxygen saturation levels (SpO2) and pulse rate. The oximeter features a digital display showing SpO2 percentage, pulse rate in beats per minute, and perfusion index.

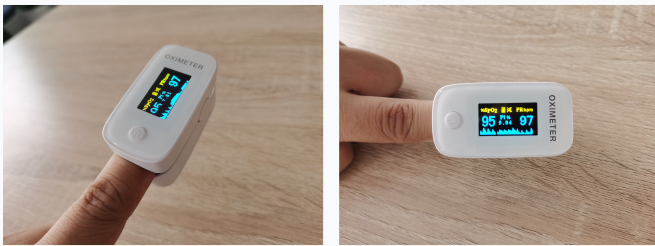

ADDITIONAL IMAGES



Product Overview

Professional Portable Monitoring

This portable digital pulse oximeter provides non-invasive, real-time monitoring of blood oxygen saturation levels (SpO2) and pulse rate (PRbpm). Designed for both home and clinical environments, the device features a clear digital display that shows vital metrics including SpO2 percentage, pulse rate, and the perfusion index (PI). Its compact and lightweight construction ensures convenient portability for on-the-go health tracking.

Key Features

Display Metrics

95 %

Typical SpO2 Reading

97 BPM

Pulse Rate

5.04 %

Perfusion Index

Measurement Capabilities

SpO2 Monitoring, Pulse Rate Tracking, Perfusion Index (PI) Display, Non-invasive

Design & Usability

Device Attributes

- Portable and lightweight design
- Digital display with pulse bar graph
- Battery-powered operation
- Simple finger-placement measurement

Usage Environment

Home Use • Clinical Settings • Portable