

# Plastic Injection Molding Machine

This plastic injection molding machine is engineered for efficient and precise manufacturing. It features a robust hydraulic system and an advanced control panel for parameter adjustments.



## Overview



The NPC 730 model, showcasing its robust build and high-capacity hopper.

### High-Performance Injection Molding

The NPC 730 is a high-performance plastic injection molding machine engineered for precision, stability, and high-volume production. It features a robust clamping unit with a diagonal dual-toggle mechanism, a balanced dual-cylinder injection system, and an advanced, energy-saving servo control architecture. Designed for durability and ease of maintenance, this machine integrates seamlessly into modern manufacturing networks, offering reliable performance across a wide range of thermoplastic applications.

## Clamping Unit

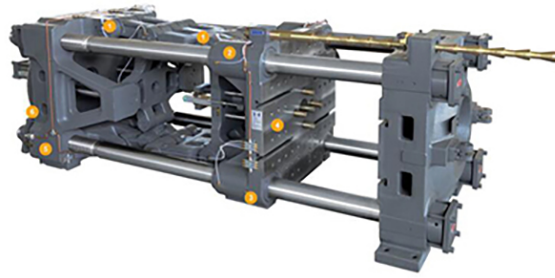

The optimized one-piece front connecting rod ensures rigidity and smooth operation.

### Technical Specifications

Parameter	Value
Open Stroke	970 mm
Space Between Tie Bars	970 x 970 mm
Max Mold Height	960 mm
Min Mold Height	400 mm
Ejector Stroke	280 mm
Ejector Force	210 kN

### Key Features

- Diagonal type dual toggle mechanic mould clamping mechanism
- One-piece casting of the connecting rod
- Automatic centralized lubrication system
- Automatic mould adjustment function
- Triple mechanical, hydraulic, and electrical interlocking protection

Clamping Force	7300 kN
----------------	---------

## Injection Unit



Dual-cylinder injection system designed for accurate and stable operation.

### Performance Metrics

Screw Diameter	Injection Weight (ps)	Injection Pressure
90	2663	206
95	2967	185
105	3625	151
110	3977	138

### System Capabilities

- Dual-cylinder balanced injection system
- High-torque oil motor drive screw preplasticizing
- Screw draw-back anti-drooling device
- Multi-stage injection pressure/speed & position control
- Hopper temperature control by computer PID

## Hydraulic System



High-efficiency hydraulic system using imported components for rapid response.

### System Highlights

- High-efficient and energy-saving servo control system
- Proportionally optimized multi-pump control system
- Flaring type seamless steel pipe to prevent oil leakage
- Optimized oil circuit combining inserts and slide valves
- Imported hydraulic components for improved response speed

## General Specifications

NPC730模板图, 机器外型图 Platen Figure Machine Exterior Figure

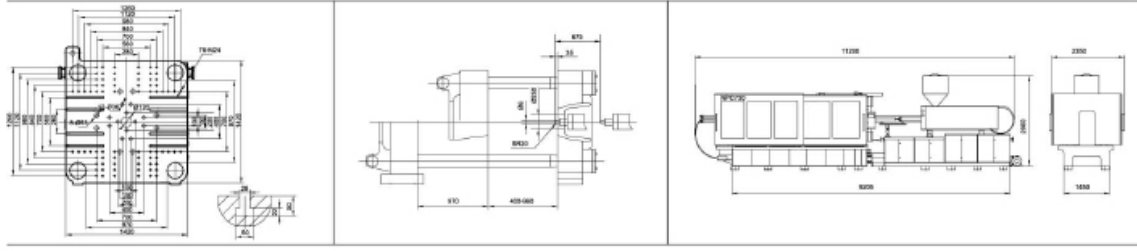

Technical diagram showing exterior dimensions and platen layout.

### Power Requirements

**81 kW**

Total Power

**1180 L**

Oil Tank Capacity

### Physical Dimensions

11.2 x 2.35 x 2.90 m

### Machine Weight

32.6 t