

Pin Teeth Core Barrel

This core barrel is a specialized drilling tool used for efficient rock drilling and piling operations. It features a robust cylindrical body with pin teeth arranged to maximize drilling performance in various geological formations.

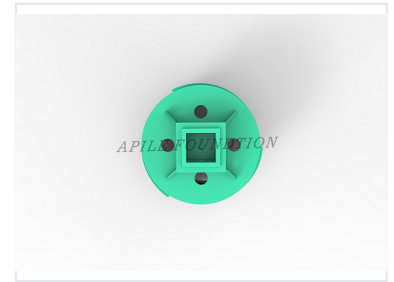

ADDITIONAL IMAGES



Overview

Pin Teeth Core Barrel

The Pin Teeth Core Barrel is a specialized drilling tool designed for efficient rock drilling and piling operations. Engineered with a robust cylindrical body and a spiral flighting configuration, it facilitates effective cuttings removal while ensuring borehole stability. The cutting head utilizes durable hard alloy pin teeth, making it an ideal solution for demanding geotechnical applications and foundation construction.

Technical Specifications

Cutting Tool Material	Hard alloy sheet
Applicable Formations	Reinforced concrete, Very hard rock
Customization	Yes
Customization Note	Technical parameters can be customized according to customer needs.