

Pillow Block Ball Bearing Unit with Cast Iron Housing

This pillow block ball bearing unit is designed for mounting on surfaces parallel to the shaft axis. It features a cast iron housing, a grease fitting for relubrication, and a standard radial ball bearing insert.

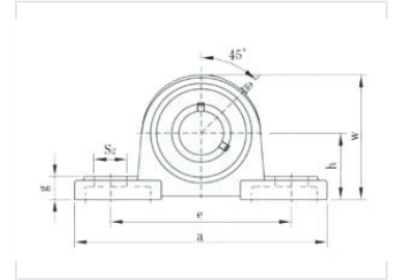

Product Overview

Industrial Pillow Block Bearing

This pillow block ball bearing unit is engineered for reliable performance in industrial machinery, featuring a robust cast iron housing designed for mounting on surfaces parallel to the shaft axis. It incorporates a standard radial ball bearing insert and includes a grease fitting to facilitate easy relubrication, ensuring extended service life. Ideal for conveyor systems and agricultural equipment, this unit is built to handle moderate loads and operational speeds effectively.

Technical Specifications

Housing Material	Cast Iron
Lubrication	Yes
Grease Fitting Angle	45 °
Common Applications	Conveyor Systems, Agricultural Machinery, Industrial Equipment

Design Features

Performance Profile

1 Moderate
Load Capacity

1 Moderate
Speed Rating

Mounting Orientation	Parallel to shaft axis
----------------------	------------------------