

Pillow Block Ball Bearing Unit

These ball bearing units are designed for robust performance in industrial applications. The units feature a high-quality, pre-lubricated and sealed ball bearing insert housed in a sturdy cast iron pillow block for easy mounting and alignment.

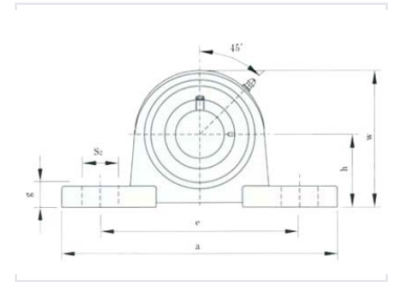

Product Overview

Robust Industrial Performance

The SALLPOJ series pillow block ball bearing units are engineered for reliable performance in demanding industrial environments. Each unit features a high-quality ball bearing insert housed within a sturdy cast iron pillow block, ensuring durability and stability. Designed for ease of use, these units are pre-lubricated and sealed to minimize maintenance requirements, while the housing facilitates straightforward mounting and alignment.

Technical Specifications

Housing Material	Cast Iron
Lubrication	Pre-lubricated
Sealing	Sealed
Grease Fitting Angle	45 °

Installation Data

Installation Parameters	a, e, h, H, S2
-------------------------	----------------