

Pillow Block Ball Bearing Unit

This pillow block ball bearing unit is designed for mounting on surfaces parallel to the shaft axis. The unit features a robust housing and a self-aligning bearing insert to accommodate shaft misalignment.

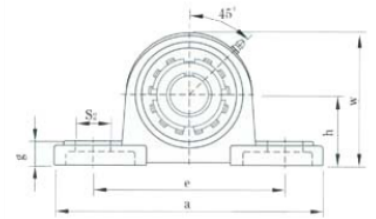

Product Overview

UKP200 Series Pillow Block Unit

The UKP200 series pillow block ball bearing unit is engineered for reliable rotational support in industrial applications. Designed for mounting on surfaces parallel to the shaft axis, this unit features a robust housing paired with a self-aligning bearing insert to effectively accommodate shaft misalignment. It is built for ease of installation and maintenance, incorporating a grease fitting positioned at a 45-degree angle for convenient lubrication.

Technical Specifications

| | |
|---------------------|---|
| Series | UKP200 |
| Lubrication Fitting | 45-degree angle grease fitting |
| Key Features | Self-aligning, Robust housing, Parallel mounting, Easy installation |

Dimensions

Key Dimensions

- Overall length (a)
- Base length (e)
- Height (h)
- Bearing width (w)
- Bolt hole spacing (S2)