

Original Equipment Fit Wiper Blade

This OE fit wiper blade ensures clear visibility during inclement weather. Its robust construction and optimized profile guarantee consistent contact with the windshield surface for streak-free wiping.

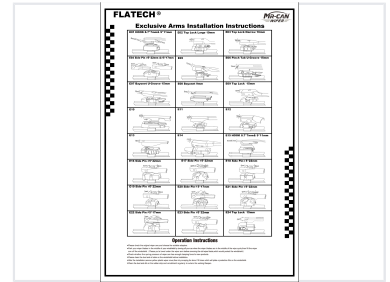

ADDITIONAL IMAGES

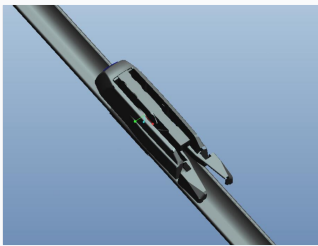

Overview

Professional Grade Wiper Performance

This Original Equipment fit wiper blade is engineered for maximum contact with modern, highly curved windshields. Featuring a memory-curved steel spring, it provides even pressure distribution for a consistently clear, streak-free wipe in all weather conditions. Designed for universal compatibility, it fits over 99% of vehicles worldwide with an easy-to-install, OE-quality construction.

Compatibility & Installation

Vehicle Compatibility	99 %
Supported Adapters	Hook, Top Lock, Side Pin, Bayonet, Pinch Tab U-Groove
Included Adapters	More than 8

Technical Features

Key Design Features

Memory Curved Steel Spring • Aerodynamic Profile • All-Weather Performance • OE Quality

Performance Highlights

10 Initial

Dry Scrape Cycles

Material	Teflon-coated rubber and polymer blend
----------	----------------------------------------

Installation Guide

Installation Procedures

- Park wipers in mid-cycle and turn off ignition
- Place towel under wiper arm to protect windshield
- Clean dust and oil from windshield before installation
- Remove yellow plastic protective cover after installation
- Perform 10 dry scrapes to plate protective film