

Mushroom Head Emergency Stop Push Button Switch with Lockout

This is a mushroom head emergency stop push button switch with a lockout feature. The switch is designed for use in industrial control applications where immediate shutdown is required.



Product Overview



Specializing in production of buttons and indicators since 1997
Mushroom head emergency stop push button switch for industrial safety applications.

Mushroom Head Emergency Stop Switch

This emergency stop push button switch is engineered for high-reliability industrial control circuits. Featuring a robust mushroom head design, it ensures immediate and intuitive activation for critical safety shutdown procedures. The unit is built to withstand harsh environmental conditions with high vibration and impact resistance, complying with international IEC standards for safety and performance.

Electrical Specifications

Electrical Performance

| | | | |
|--------------------------------|--------------------------------|--------------------------------|--------------------------------|
| 660 V Max AC Voltage | 400 V Max DC Voltage | 10 A Thermal Current | 6 kV Impulse Voltage |
|--------------------------------|--------------------------------|--------------------------------|--------------------------------|

Contact Characteristics

Slow breaking, NC contact, NO contact

Environmental Durability

Protection Rating

IP65 • IP66 • IP67 • IP68

Operating Temperature Range

-5°C to +55°C

Technical Standards

Compliance and Standards

CE, ISO9001, RoHS, UL, IEC60947-5-1, GB/T14048.1

Mechanical Data



XDL32-ET45

Emergency stop
Push-pull
IP65
N/O+N/C

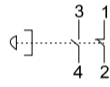

● Red $\Phi 40$ XDL32-ET45

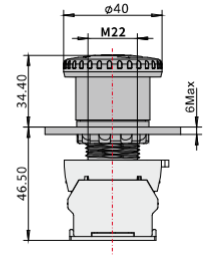

Technical diagram showing the push-pull configuration and mounting dimensions.

Lifespan Operations

| Type | Cycles |
|-----------------------|---------|
| Standard Pushbutton | 3000000 |
| Emergency Stop Button | 300000 |

Fastening Torque 0.8 Nm