

# Mini LED Indicator Light with Red Lamp

This mini LED indicator light features a red lamp for clear signaling. It is designed for use in control panels, machinery, and other industrial equipment.



## Overview



## High-Performance LED Signaling

The AD22-16DS series represents a modern advancement in indicator technology, utilizing high-brightness LED chips as a long-lasting and low-consumption alternative to traditional incandescent and neon lamps. These compact indicators are designed for high reliability and aesthetic appeal, featuring a durable polycarbonate lampshade with superior anti-surge performance. Engineered for versatility, they are ideal for signaling, forewarning, and accident indication across electrical power, telecommunications, and industrial machinery sectors.

## Technical Specifications

Voltage of Working Frequency	2.5kV (AC valid value), 1min
Insulated Resistance	eMI©
Voltage Wave Allowed	±20%
Rated Current	20 mA
Compliance Standards	IEC947-6-1, EN50947-5-1, IEC/EN 60947-5-1



## Physical Dimensions



**AD22-16DS**

Protected  
**LED**  
Indicator

24V AC/DC  
36V AC/DC  
48V AC/DC  
110V AC  
127V AC  
220V AC

-  Red
-  Green/PG
-  Yellow
-  Pure Blue
-  White/PW

**AD22-16DS**

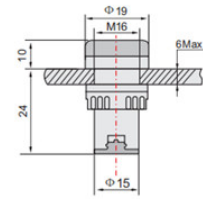

## Mounting Specifications

**19 mm**

Mounting Hole (I)

**16 M**

Thread Size

**6 mm**

Max Panel Thickness

**24 mm**

Total Length

## Options & Variants

### Available Colors

Red • Green • Yellow • Pure Blue • White

### Voltage Options

- 24V AC/DC
- 36V AC/DC
- 48V AC/DC
- 110V AC
- 127V AC
- 220V AC
- 230V AC

## Application Areas

### Target Industries

Electrical Power, Telecommunication, Machine Tools, Watercraft, Textile, Printing, Mine Machinery

## Product Features

### Key Benefits

- Long operational life
- Low power consumption
- Small volume and light weight
- High brightness LED source
- Anti-surge polycarbonate lens
- Safe bolt-type connectors