

Electrical Specifications

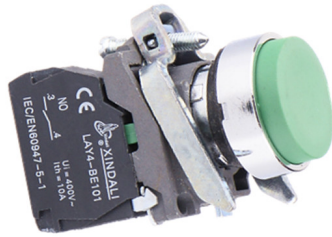

Specializing in production of buttons and indicators since 1997

Robust metal construction with clearly labeled contact terminals.

| | |
|------------------------------|---------------|
| Rated Insulation Voltage | 600 V |
| Conventional Heating Current | 10 A |
| Insulation Resistance | e50M Ω |
| Contact Resistance | d25m Ω |
| PF Withstand Voltage | AC 2.5KV/min |

Mechanical & Durability



LAY4-BL42

Projecting
push button
Spring return

N/O



N/C

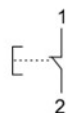

- Black LAY4-BL21
- Green LAY4-BL31
- Blue LAY4-BL61
- Yellow LAY4-BL51
- Red LAY4-BL42

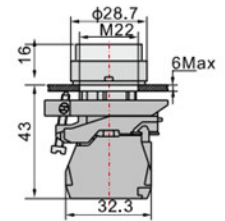

Dimensional specifications including M22 mounting hole and head diameter.

| | |
|------------------------------|---------|
| Mechanical Life (Pushbutton) | 1000000 |
| Electrical Life (Pushbutton) | 5000000 |
| Mounting Hole Diameter | 22 mm |
| Maximum Panel Thickness | 6 mm |

Compliance & Certifications

Standards Compliance

IEC60947-5-1 • GB/T14048.1

Certifications

CE, ISO9001, RoHS, UL