

Inner Wall Cylinder Brush

This cylinder brush is designed for painting inner walls. It features a 230mm (9") roller and is suitable for middle-density surfaces.

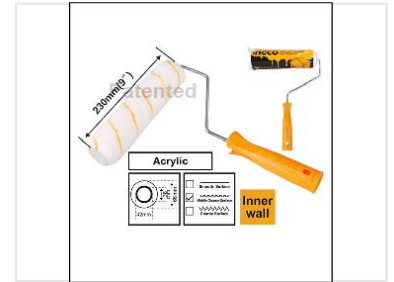

Product Overview

Professional Inner Wall Cylinder Brush

This high-quality cylinder brush is specifically engineered for efficient inner wall painting applications. Featuring a 230mm (9-inch) roller width, it is optimized for consistent coverage on middle-dense surfaces. The design includes a robust 6mm central shank, ensuring stability and ease of use for professional painting tasks.

Technical Specifications

Roller Size

230 mm
Width

9 in
Width

Fibre Height 12 mm

Central Shank Diameter 6 mm

Application Details

Material Type

Acrylic

Suitable Surfaces Inner Wall, Middle Dense Surfaces