

Electronically Commutated Motor ECQ20

The ECQ20 motor is a high-efficiency motor controlled electronically. It offers multiple protections for stable, reliable, and long-lasting performance.



ADDITIONAL IMAGES



Overview

High-Efficiency EC Motor

The ECQ20 is a high-efficiency electronically commutated motor designed for reliable performance in refrigeration and HVAC systems. Engineered for stability and longevity, it features a robust IP66 protection rating and offers versatile control options, including constant speed, two-speed, and full-speed modes with CW/CCW rotation capabilities. Its design is fully compatible with traditional motor installations, allowing for seamless replacement and upgrades.

Technical Specifications

Safety Factor

IP66

Certifications

VDE (40043041), UL (E221116)

Max Efficiency

70 %

Performance Models

Model Specifications

Model	Voltage (V)	Speed (rpm)	Input Power (W)	Mass (kg)
ECQ20A230	198-253	1300/1550	30/20	0.7
ECQ20A115	90-128	1300/1550	30/20	0.7

Airflow Configuration

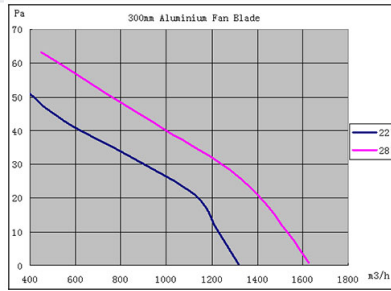

Airflow performance characteristics for 300mm fan blade configurations at 22 and 28 degree angles.

Impeller Performance

Impeller Diameter (mm)	Blade Angle (°)	Input (W)
254	15	20.5
300	22	20.5

Dimensions

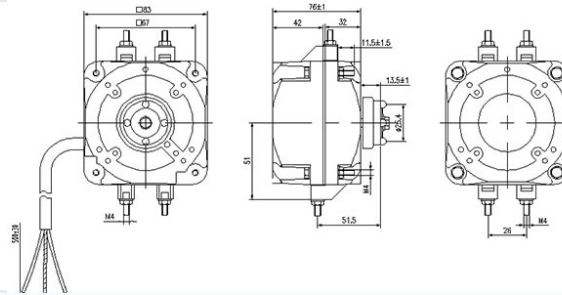

Dimensional drawing illustrating the compact design and mounting specifications for easy installation.

Physical Dimensions

83 mm

Face Width

76 mm

Overall Depth

25.4 mm

Shaft Diameter

500 mm

Cable Length