

# Eccentric Bearing Unit UK300

This eccentric bearing unit is designed for precise shaft alignment and smooth rotational motion. Its robust bearing insert within a sturdy housing ensures durability and reliability.

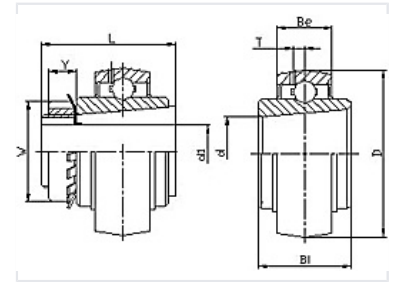

## Overview

### High-Precision Eccentric Bearing Unit

The UK300 is a compact eccentric bearing unit engineered for precise shaft alignment and smooth rotational motion. Featuring a robust bearing insert housed in a sturdy assembly, it provides exceptional reliability and durability in demanding industrial environments. The integrated eccentric collar simplifies adjustment, allowing for the compensation of misalignments while effectively reducing operational vibration.

## Key Features

### Suitable Applications

Conveyor Systems, Packaging Equipment, Textile Machinery

## Technical Dimensions

### Dimensional Parameters

- L: Overall Length
- B1: Housing Width
- Be: Bearing Width
- d1: Bore Diameter
- D: Outer Diameter

### Additional Geometry

- Y
- V
- T

## Maintenance

### Service Life Features

Lubrication Port • Integrated Sealing