

# Double Head Flush Push Button with Rubber Cap

This double-headed push button is designed for elevator control panels. It features a flush mount and a rubber cap for durability.

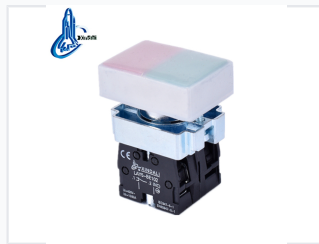

## ADDITIONAL IMAGES



## Overview

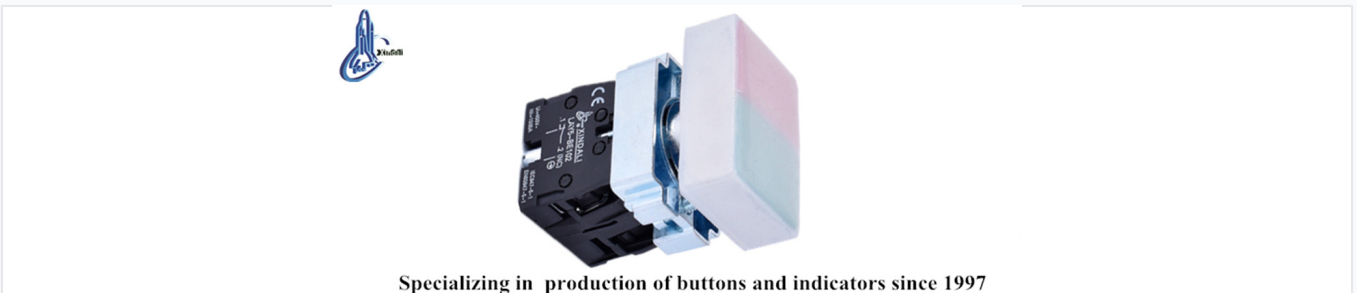

Specializing in production of buttons and indicators since 1997

Double-headed design allows for two separate control functions in one unit.

## Double Head Flush Push Button

This double-headed flush push button is designed for reliable control in elevator panels and industrial circuits. Featuring a durable rubber cap for enhanced protection and comfort, it offers a space-saving design with two distinct control functions in a single unit. Built with high-grade zinc alloy and anti-flame plastic, it ensures longevity and safety in demanding electrical environments.

## Electrical Ratings

Rated Insulation Voltage	600 V
Conventional Heating Current	10 A
Insulation Resistance	e5M©
Contact Resistance	d25©
Power Frequency Withstand Voltage	AC 2.5KV/min

## Performance

### Mechanical Life

**1000000 cycles**

Pushbutton

**500000 cycles**

Selector Switch

### Electrical Life

**5000000 cycles**

Pushbutton

**250000 cycles**

Selector Switch

## Physical Specifications



LAY5-BL9325

Without pilot light  
1 flush green button  
1 flush red button  
(with water-proof cover)  
Unmarked IP65

N/O

+

N/C

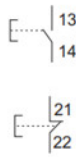

LAY5-BL9325

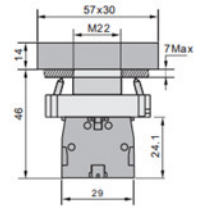

Detailed dimensions and contact configuration, including N/O and N/C terminals.

### Ingress Protection

IP65

### Dimensions

57 x 30 mm (Top Section)

### Mounting Thread

M22

## Compliance

### Certifications & Standards

CE, ISO 9001, RoHS, UL, IEC60947-5-1, GB/T14048.1