

# DC Motor for Central Locking Systems

This DC motor is engineered for central locking systems in vehicles. It provides efficient and reliable actuation for automotive security applications.

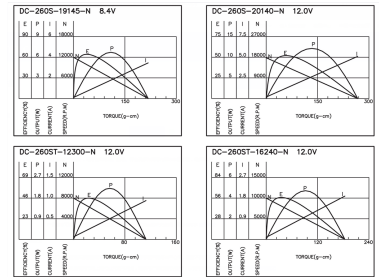

## ADDITIONAL IMAGES

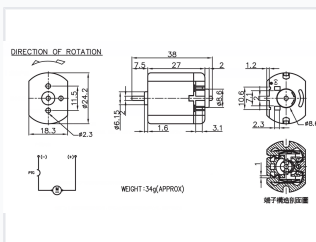

## Overview

### High-Efficiency Central Locking Actuator Motor

This compact carbon-brush DC motor is engineered specifically for automotive central locking systems and security applications. Featuring a robust metal housing and durable plastic end cap, it ensures reliable actuation and long-term performance. The design includes an integrated PTC thermistor for essential overload protection, making it a safe and efficient choice for demanding automotive environments.

## Physical Dimensions

Motor Length	38 mm
Motor Diameter	24.2 mm
Shaft Diameter	6.15 mm
Approximate Weight	34 g

## Mounting & Connectivity

Mounting Hole Diameter	2.3 mm
Mounting Hole Spacing	18.3 mm
Terminal Spacing	2.3 mm

## Technical Features

Protection Features	PTC Thermistor, Overload Protection
Motor Type	Carbon-brush DC motor

## Performance Data

### Available Motor Models

Model	Voltage
DC-260S-19145-N	8.4V
DC-260S-20140-N	12.0V
DC-260ST-12300-N	12.0V
DC-260ST-16240-N	12.0V