

# Benchtop Dispensing Machine for Dual Cartridge Adhesives

This benchtop dispensing machine is designed for the precise and efficient dispensing of adhesives from 50ml dual cartridges. It is suitable for applications requiring controlled and accurate dispensing of adhesives, sealants, and other fluids.

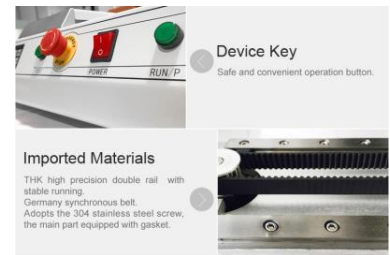

## ADDITIONAL IMAGES

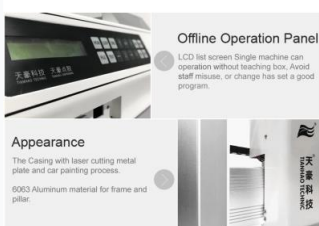

## Overview

### Precision Dispensing for Dual Cartridges

This benchtop dispensing machine is engineered for high-precision application of two-part adhesives, such as epoxy resin and AB glue, packaged in 50ml dual cartridges. Featuring a robust design with high-precision stepper motors and linear guides, it ensures consistent, repeatable dispensing for complex patterns including 3D lines, circles, and arcs. Designed for industrial efficiency, this system helps reduce material waste and improves overall product quality in assembly environments.

## Key Features

<b>Certifications</b>	CE Approved
<b>Compatible Materials</b>	AB Glue, Epoxy Resin, Two-part Glue

## Technical Specifications

### Working Area Options

Model	Range (X/Y/Z)	Dimensions (WxDxH)	Weight
TH-2004D-300	300x300x100mm	500x580x610mm	37.5
TH-2004D-400	400x400x100mm	600x680x610mm	42.5
TH-2004D-500	500x500x100mm	700x780x610mm	49.5

### Operating Conditions

- Temperature: 0 to 40°C
- Humidity: 20 to 90% (No condensation)

<b>Power Supply</b>	AC110V/220V (Internal conversion)
<b>I/O Signals</b>	4 Inputs / 4 Outputs

## Performance Metrics

### System Performance

**800 mm/s**

X/Y Speed

**350 mm/s**

Z Speed

**9999 programs**

Memory Capacity