

# Automotive Precision Bearing

This high-precision auto bearing is designed for optimal performance and durability in automotive applications. The bearing features robust construction with precision-engineered components to ensure smooth and reliable operation.

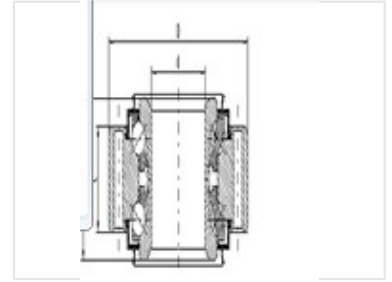

## Product Overview

### High-Precision Automotive Bearing

This high-precision automotive bearing is engineered for optimal performance and long-term durability in demanding automotive environments. Featuring robust construction with precision-engineered components, it ensures smooth, reliable operation and efficient load distribution. Designed to meet or exceed OEM specifications, this component provides an ideal solution for maintaining vehicle performance and reducing friction.

## Technical Specifications

### Key Performance Metrics

**1 Optimized**

Friction Reduction

**100 %**

OEM Specification Compliance

### Construction Quality

Precision-Engineered • Robust Design • Durable

### Application Compatibility

Automotive, OEM Replacement, High-Load