

# Automotive Air Balance Spring

Air balance springs are essential components in automotive suspension systems. They ensure optimal air distribution and pressure regulation for enhanced vehicle stability.

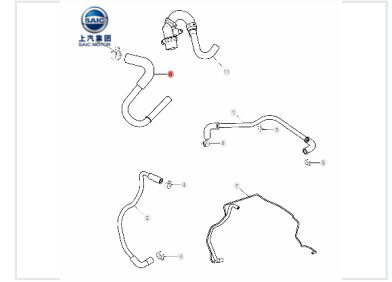

## ADDITIONAL IMAGES



## Product Overview

### Automotive Air Balance System

This air balance spring assembly is designed to facilitate precise air distribution and pressure regulation within automotive systems. Engineered for reliability, the component features a complex routing configuration to ensure optimal performance and system integrity. It is a critical spare part essential for maintaining the operational efficiency of vehicle air management systems.

## Technical Details

### Assembly Connection Points

- 1
- 2
- 3
- 4
- 5
- 6
- 7
- 11

Component Type	Air Balance Spring Assembly
Part Identifiers	S0210065

## Logistics

### Packaging Standards

Safe Packing • Quick Delivery