

# AC Capacitor Motor for Home Appliances

This AC capacitor motor is designed for use in home appliances such as electric fans. It features a robust construction with a laminated stator core and copper windings for enhanced performance.

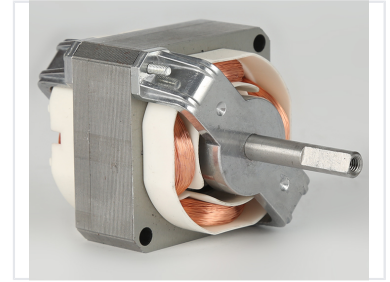

## Overview

### EF55 Series Capacitor Motor

The EF55 series capacitor motor is a compact, high-efficiency electric motor engineered for reliable performance in small appliances such as electric fans and pumps. It features a robust, square-shaped laminated stator core for superior magnetic performance and copper windings with high-temperature insulation for extended lifespan. With a dynamically balanced rotor to minimize noise and vibration, this motor offers a dependable solution for various home appliance applications.

## Technical Specifications

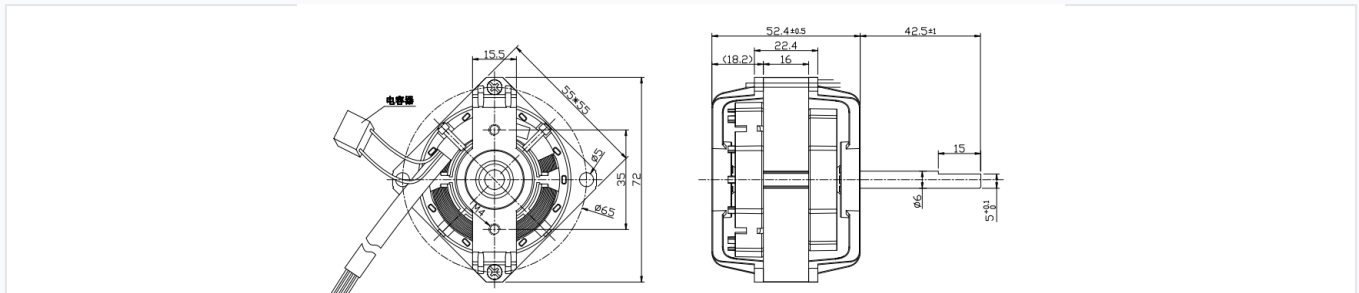

Dimensional schematic of the EF55 series motor, detailing mounting hole placement and shaft extension.

### Dimensions

Feature	Value
Stator Size	55 x 55 mm
Total Height	72 mm
Motor Width	52.4 ± 0.5 mm
Shaft Diameter	6 mm
Shaft Extension	15 mm

### Mounting & Installation

- Mounting hole diameter: 5 mm
- Distance from base to center of mounting holes: 35 mm
- Mounting type: M4 screws

## Construction & Materials

Build Quality	Laminated Stator Core, Copper Windings, Dynamically Balanced Rotor, Hardened Steel Shaft, Die-cast Aluminum/Plastic End Shields
---------------	---

## Applications

### Recommended Applications

Electric Fans • Pumps • Small Home Appliances