

6-20mm Ballnose End Mill Grinder

This is a specialized grinder for ball end mills. Grinding is accurate, rapid, and easy, requiring no prior skill.

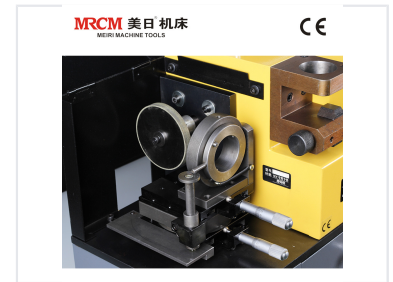

ADDITIONAL IMAGES



Product Overview



Compact and robust design suitable for tool rooms and manufacturing environments.

Precision Ballnose End Mill Grinding

This specialized grinding machine is engineered for the rapid and accurate sharpening of ballnose end mills. Designed for ease of use, it requires minimal operator skill to achieve professional-grade results. With a robust construction and high-performance grinding capabilities, it ensures consistent cutting edge geometry, helping to extend tool life and optimize machining performance in professional workshop environments.

Technical Specifications

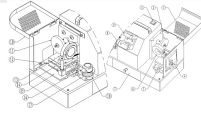

1 Spindle lock
2 Right hand grinding wheel
3 Grinding wheel guard
4 Spindle lock
5 Grinding wheel guard
6 Spindle lock
7 Right hand grinding wheel
8 Grinding wheel guard
9 Spindle lock
10 Grinding wheel guard
11 Spindle lock
12 Right hand grinding wheel
13 Grinding wheel guard
14 Spindle lock
15 Grinding wheel guard
16 Spindle lock
17 Right hand grinding wheel
18 Grinding wheel guard
19 Spindle lock
20 Grinding wheel guard
21 Spindle lock
22 Right hand grinding wheel
23 Grinding wheel guard
24 Spindle lock
25 Grinding wheel guard
26 Spindle lock
27 Right hand grinding wheel
28 Grinding wheel guard
29 Spindle lock
30 Grinding wheel guard



Detailed view of machine controls, including transverse feed plate and fine-tuning mechanisms for precise geometry adjustment.

Machine Specifications

Feature	Detail
Model	MR-X8
Power	220V / 250W
Spindle Speed	4400 rpm
Dimensions	60 x 29 x 37 cm
Weight	40 kg

Tool Compatibility

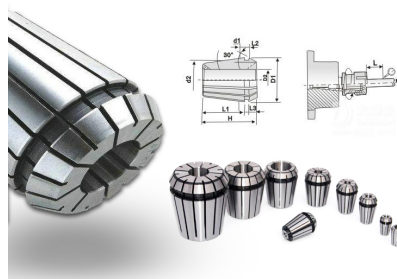

Precision collet design for secure tool holding and concentricity during grinding operations.

Processing Capacity

6 mm

Minimum Diameter

20 mm

Maximum Diameter

Included Collets

- 6
- 8
- 10
- 12
- 14
- 16
- 18
- 20

Grinding & Performance

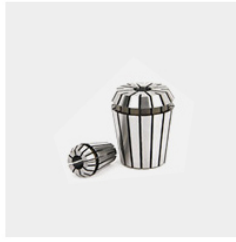

High-precision accessories including diamond grinding wheels and collet chucks designed for optimal material removal.

Grinding Wheel Compatibility

SDC (Standard for Carbide), CBN (Optional for HSS)