

## 220V AC Cooling Fan 30x30x4mm

This compact AC fan operates on 220V and measures 30x30x4mm. It is designed to provide localized cooling for electronic components and other machinery.



### ADDITIONAL IMAGES



### Product Overview



Ultra-slim 4mm profile suitable for compact electronic enclosures.

### Compact High-Performance Cooling Solution

This 220V AC cooling fan features a slim 30x30x4mm profile, making it an ideal choice for localized heat dissipation in space-constrained industrial equipment and compressors. Engineered with a die-cast aluminum housing and glass fiber reinforced plastic impellers, it offers a robust build quality designed for reliability. With options for high-precision ball bearings or quiet-running sleeve bearings, this fan provides versatile performance to maintain optimal operating temperatures in professional electronics.

### Key Performance Metrics

#### Performance Highlights

**220 V**

Rated Voltage

**8500 RPM**

Max Speed

**500 M $\odot$**

Insulation Impedance

## Technical Specifications

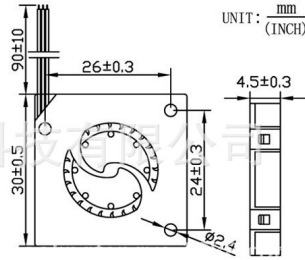
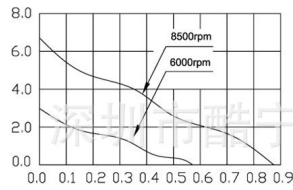

Detailed dimensional specifications and mounting hole patterns.

Physical Dimensions	30mm x 30mm x 4mm
Mounting Hole Distance	24 mm
Mounting Hole Diameter	2.4 mm

## Material & Construction

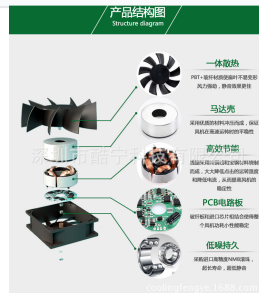

Internal view showing pure copper coils, fiberglass PCB, and high-precision bearings.

### Motor Features

- High-temperature copper line
- Pure copper wire coils
- Fiberglass PCB with integrated chips
- Sturdy motor housing for high-speed stability

Housing Material	Die-cast aluminum
Impeller Material	Glass fiber reinforced plastic (UL 94V-0 rating)

## Electrical Safety



Various terminal configurations available to suit different PCB connection requirements.

Resist Strength	2200V/S
Connection Type	Leader Wire, Terminal Connector

## Performance Data

### Operating Parameters by Model

Model	Voltage (VDC)	Current (A)	Speed (RPM)	Air Flow (CFM)	Noise (DB-A)
BA3004L33S	3.3	0.05	6000	0.57	28
BA3004L05S	5	0.075	8500	0.87	36

## Bearing System

**两种选择**  
**含油轴承和滚珠轴承**

**含油轴承 (SHL)** 采用滚动摩擦的形式, 采用了两个滚珠轴承, 轴承中心轴孔与轴配合紧密, 所以运转精度高, 且噪音低, 使用寿命长, 适合转速较高的风扇, 轴承寿命较长。

**含油轴承 (SHL)** 采用滚动摩擦的形式, 轴承中心轴孔与轴配合紧密, 所以运转精度高, 且噪音低, 使用寿命长, 适合转速较高的风扇, 轴承寿命较长。



Comparison between sleeve bearings for low noise and ball bearings for long life.

### Sleeve vs. Ball Bearings

Available with two bearing types: Oil-impregnated sleeve bearings offer lower initial noise and cost-effectiveness for standard applications. Dual ball bearings utilize rolling friction with high-precision NMB components, providing a significantly longer lifespan and stability for high-speed, continuous operation.

## Compliance & Quality

### Certifications

CE • FCC • RoHS • UL 94V-0