

Performance Metrics

Mechanical Life

1000000 cycles
Pushbutton

500000 cycles
Selector Switch

Electrical Life

5000000 cycles
Pushbutton

250000 cycles
Selector Switch

Certifications & Standards

Standards & Certifications

CE, ISO 9001, RoHS, UL, IEC 60947-5-1, GB/T 14048.1

Dimensions & Mounting



LAY5-BD21

Standard handle

N/O



2 Position stay put

LAY5-BD21

2 Position spring return

LAY5-BD41

N/O + N/C



2 Position stay put

LAY5-BD25

2 Position spring return

LAY5-BD45

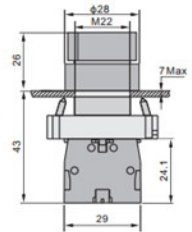

Dimensional diagram and configuration guide for standard handle switches, including mounting details.

Mounting Specifications

Parameter	Value
Panel Cutout	28mm (M22 thread)
Height Above Panel	26mm
Max Panel Thickness	7mm
Total Height	43mm
Base Width	29mm