

1.7L Stainless Steel Electric Kettle

This electric kettle features a stainless steel body and a concealed underfloor heating element. It has a 1.7L capacity and is designed for rapid water boiling.

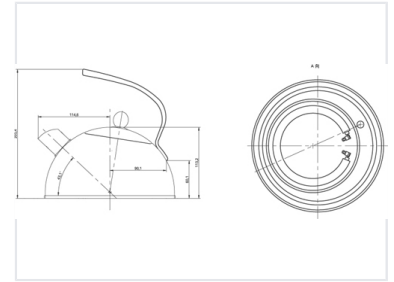

ADDITIONAL IMAGES



Product Overview

Professional Grade Stainless Steel Kettle

This 1.7L stainless steel electric kettle is engineered for high-performance boiling in professional environments. Featuring an efficient underfloor heating element, it supports rapid heating capabilities up to 3000W. Its modern, sleek aesthetic makes it an ideal addition to any commercial kitchen or office workspace.

Technical Specifications

Volume Capacity	1.7 L
Maximum Power	3000 W
Heating Mechanism	Underfloor heating element
Model ID	GMCL-21110-240V

Dimensions

Detailed Measurements

Component	Dimension
Overall Height	268.4 mm
Body Height	90.1 mm
Base Height	60.1 mm
Spout Distance	114.6 mm
Handle Height	113.2 mm
Spout Angle	43.1 degrees

Service & Customization

Design Services	Special Design on Request
-----------------	---------------------------