

130mm Series Brushless DC Gear Motor

This brushless DC gear motor features high power density, a small moment of inertia, and quick reaction. It is suitable for high-performance motion control applications, including CNC machines, industrial controls, and home appliances.



Overview

High-Performance 130mm Brushless DC Motor

The 130mm Series Brushless DC Gear Motor is engineered for high power density and long-term reliability in demanding industrial environments. It features a permanent magnet construction that provides high efficiency, low noise, and spark-free operation compared to traditional brushed motors. Designed for versatile motion control, it supports various protection functions including overvoltage and overheating safeguards, making it ideal for CNC machinery, electric vehicles, and home appliances.

Key Performance Metrics

Performance Highlights

3000 RPM

Rated Speed

785 W

Rated Power

2.5 N·m

Rated Torque

Technical Specifications

Model Specifications

Model Number	Poles	Voltage (VDC)	Power (W)	Torque (N·m)	Length (mm)	Weight (Kg)
130-BLB0D062204RN-01	8	48	785	2.5	120	5
130-BLB0J125404RN-01	8	310	1570	5	155	7

Physical Characteristics

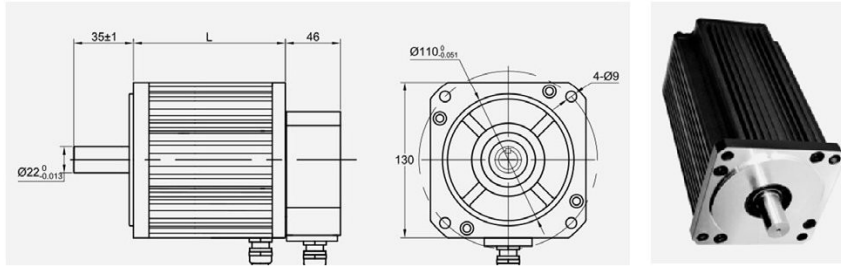

Detailed engineering drawing showing mounting dimensions, shaft diameter (22mm), and frame size for the 130mm series.

Construction	Permanent Magnet
Commutation	Brushless
Shaft Diameter	22 mm
Mounting Flange Size	130 mm

Operational Standards

Protection Class	IP40 • IP65 Optional • Waterproof
Work Duty	<ul style="list-style-type: none">• S1 (Continuous)• S2• S3
Insulation Class	Class B, Class F

Applications

Target Applications	CNC Machine Tools, Electric Bicycle, Industrial Control, Home Appliances, Boat, Car
---------------------	---

Certifications

Compliance	CCC • CE
------------	----------